



ENGINEERED

# ADRENALINE FOR THE SERIOUS RACER

2007.5-2009 DODGE CUMMINS L6-6.7L (td)



**RACE USE IN COMPETITION ONLY!**



**THIS PART IS FOR RACE USE ONLY**

This is a "Race Only" Product Used solely for Competition. Its use is limited to closed-course and open-course racing that is formally sanctioned by a recognized racing organization. Any other use, including recreational off-road use, could be in violation of local, state and federal laws. This system also requires an aftermarket electronic module to work properly with the vehicle.

## DPF-DELETE SYSTEMS

Dodge RAM 2500/3500

**49-42020 4" DPF-Delete Race Pipe**

- 4" 409 Stainless Steel, connects to OE Down Pipe
- Eliminates Cat & DPF
- Sensor bungs and band clamp included
- Factory style hangers

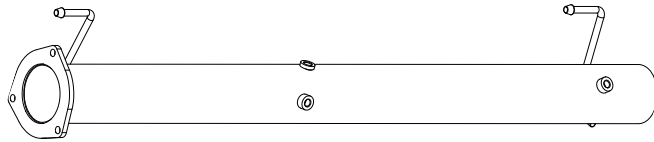

P/N	MATERIAL	L x W x H	WGT	UPC	MSRP	MAP
49-42020	409 SS	53" x 18" x 24"	16 lbs	802959495186	\$251.25	\$201.00

P/N	MATERIAL	L x W x H	WGT	UPC	MSRP	MAP
49-42020	409 SS	53" x 18" x 24"	16 lbs	802959495186	\$251.25	\$201.00

**49-42021 4" Turbo Downpipe Race Pipe**

- 4" 409 Stainless Steel, replaces stock downpipe
- Mandrel-bent, 2 piece
- Sensor bungs and band clamp included
- Factory style hanger

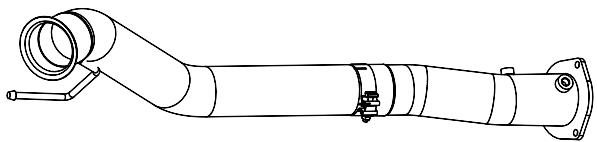

P/N	MATERIAL	L x W x H	WGT	UPC	MSRP	MAP
49-42021	409 SS	48" x 10" x 10"	15 lbs	802959495193	\$251.25	\$201.00

P/N	MATERIAL	L x W x H	WGT	UPC	MSRP	MAP
49-42021	409 SS	48" x 10" x 10"	15 lbs	802959495193	\$251.25	\$201.00

**49-42023 4" Downpipe/DPF-Delete Race Pipe Combo**

- 4" 409 Stainless Steel, connects to OE turbo
- Slip-fit 3 piece design for lighter weight
- Sensor bungs and band clamp included
- Factory style hanger

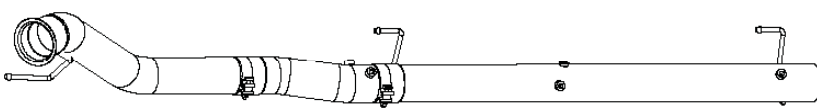

P/N	MATERIAL	L x W x H	WGT	UPC	MSRP	MAP
49-42023	409 SS	60" x 14" x 19"	34 lbs	802959494691	\$336.25	\$269.00

P/N	MATERIAL	L x W x H	WGT	UPC	MSRP	MAP
49-42023	409 SS	60" x 14" x 19"	34 lbs	802959494691	\$336.25	\$269.00

YEAR	MAKE	MODEL	ENGINE	DESCRIPTION
2007.5-2009	Dodge	RAM 2500/3500	L6-6.7L td)	aFe Mach Force XP Race Pipes

Dodge RAM 4500/5500 (Cab & Chassis)

**49-42022 4" DPF-Delete Race Pipe (Cab & Chassis)**

- 4" 409 Stainless Steel, connects to OE Down Pipe
- Eliminates Cat & DPF
- Sensor bungs and band clamp included

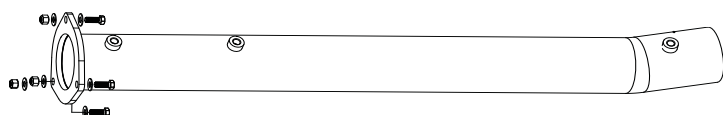

P/N	MATERIAL	L x W x H	WGT	UPC	MSRP	MAP
49-42022	409 SS	53" x 18" x 24"	29 lbs	802959495209	\$311.25	\$249.00

P/N	MATERIAL	L x W x H	WGT	UPC	MSRP	MAP
49-42022	409 SS	53" x 18" x 24"	29 lbs	802959495209	\$311.25	\$249.00

YEAR	MAKE	MODEL	ENGINE	DESCRIPTION
2007.5-2009	Dodge	RAM 4500/5500	L6-6.7L td)	aFe Mach Force XP Race Pipes

Notes: These systems require the use of an aftermarket module to work properly with the vehicle.