



INSTALLATION INSTRUCTIONS

P/N 75-5038

VEHICLE APPLICATION

**2004-2005 Chevrolet
Silverado 2500 & 3500
2004-2005 GMC
Sierra 2500 & 3500
6.6L Duramax Diesel "LLY"**

- * Kit may not fit vehicles with the following **Aftermarket Parts** installed.
- * **Body Lift**
- * **Custom Hood**
- * **Turbo Upgrade**
- * **Intercooler Upgrades**

PARTS LIST

QTY	DESCRIPTION	QTY	DESCRIPTION
1	(O) Intake Tube	1	(F) # 80 Hose Clamp
1	(E) Air Box	1	(L) # 72 Hose Clamp
1	(K) Air Box Adapter	2	(P) # 64 Hose Clamp
1	(D) Air Filter	2	(Q) 5/16-18 SS Screw
1	(J) Hump Adapter	1	(C) Clear Lid
1	(M) Step Adapter	4	(A) SS Concave Washer
1	(H) MAF Gasket	4	(B) SS 10/24 Phillips Screw
2	(I) M4 MAF Screw	1	(N) # 60 Hose Clamp
2	(G) M4 Rubber Washer	4	(R) M6 Allen Head Screw
		4	(S) 3/8"x1" SS Washer

TOOLS REQUIRED

- 10 mm Wrench or Socket
 - 12mm Socket
 - 5/16" Nut driver or
 - Flat Blade Screwdriver
 - Phillips Screwdriver
 - T-20 Torx Wrench (supplied)
 - 4mm Allen Wrench
- Your S&B Air Filter P/N KF-1035 is factory oiled and ready to use. When serviced it will require 87g (main body) plus 17g (top) of S&B Filter Oil.

1. With the ignition switched off, place vehicle in Park and or set Parking Brake. Then disconnect both negative battery cables.



5. Remove the OE foil from the inner fender, this will allow cooler air to enter the S&B Air Box (E).



9. Slide the Step Adapter (M) over the small end of the S&B Intake Tube (O) and secure the # 64 Hose Clamp (P).



2. Loosen the hose clamps at the OE air box and at the turbo inlet, then remove the OE intake tube.



6. Remove the OE air box tray. If long enough you may use four of these bolts to secure the S&B Air Box (E) to the vehicle. If not use the M6 Allen head screws (R) and SS washers (S).

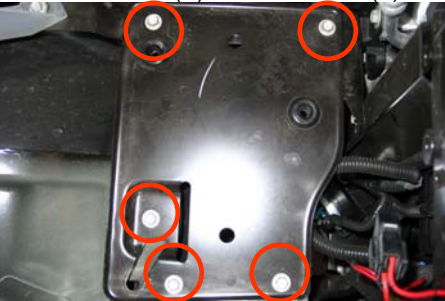

10. Slide the large side of the Hump Adapter (J) over the large end of the S&B Intake Tube (O) until the small side hits the end of the tube.



3. Disconnect the MAF sensor electrical connection.



7. Attach the S&B Filter Adapter (K) to the S&B Air box (E), secure using the 5/16 screws (Q) provided.



11. Place the # 60 Hose Clamp (N) over the turbo inlet and a # 64 Hose Clamp (L) over the filter adapter (K). Then slip the S&B Intake Tube assembly over the turbo inlet, align the large end of the tube to the filter adapter then secure the # 60 hose clamp (N).



4. Lift up and pull towards the engine to remove the OE air box from the vehicle.



8. Place the S&B Air Box assembly into the vehicle, align the 4 holes with the OE mounting locations and secure using either the OE bolts or the supplied hardware. You may need to loosen these bolts to align the tubes properly during step # 12 then retighten.



12. Slide the S&B Hump Adapter (J) over the filter adapter (K), center over the gap between the tubes and secure the #72 and #64 Hose Clamps (L).





INSTALLATION INSTRUCTIONS (continued)

13. Use the T-20 Security Torx Tool supplied and remove the MAF Sensor from the OE air box.



14. Peel the backing from the MAF Sensor Gasket (H) before placing it over the sensor, sticky side down.

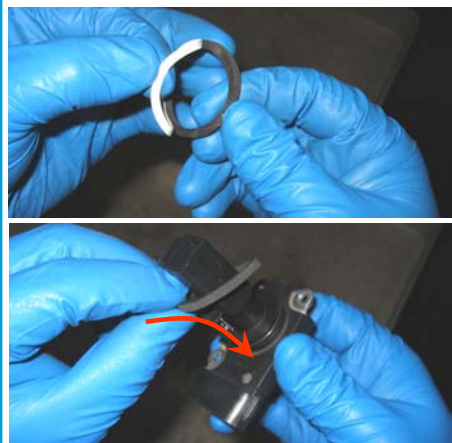

15. Place the M4 screws (I) through the MAF mounting holes, then place the Rubber Washers (G) over the screws. Insert the MAF sensor into the S&B Filter Adapter (K) (note the direction of air flow) and tighten the M4 screws evenly. **Do Not Over Tighten!**



16. Reconnect the MAF sensor electrical connection.



17. Place the S&B Air Filter (D) into the S&B Air Box (E), slide onto the flange and secure the # 80 Hose Clamp (F).

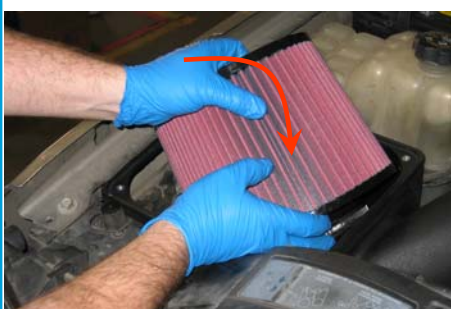

18. Remove the protective covering from the S&B Clear Lid (C).



19. Place the clear lid on the air box and secure using the 8/32 SS Screws (A) and SS Washers (B).



20. Reconnect both negative battery cables.

21. Inspect your installation, make sure kit is properly positioned and all fasteners are tight.

PERFORMANCE TESTING

- * Engage parking brake and start your engine. Listen for abnormal noises. If an air leak is detected, re-inspect hoses and connections as they may need to be repositioned and tightened.
- * S&B FILTERS recommends that you keep your OE intake system in the event it is required in the future.
- * In order to maintain your warranty, all connections and components must be checked periodically for alignment and for proper tension on all connections. Failure to do so may void your warranty.
- * Use only S&B FILTERS cleaning and oil products to service your filter. Using any other brand oil and or cleaners on your S&B air filter may void your warranty.

Smog Certification Note:

The California Air Resource Board (CARB) requires that an E.O. identification label be applied to the vehicle in order to pass a smog check inspection when a High Performance Intake Kit has been installed.

You must place the E.O. label provided on or near the intake kit after installation so that a smog check technician can easily verify the E.O. number.

FILTER CLEANING & OILING

PRECISION

CLEANING & OILING KIT

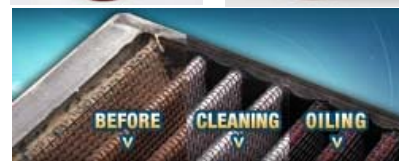

Order online today at www.sbfilters.com or through your local S&B distributor



S&B PERFORMANCE FILTERS & INTAKE KITS

S&B PART NUMBER
75-5038

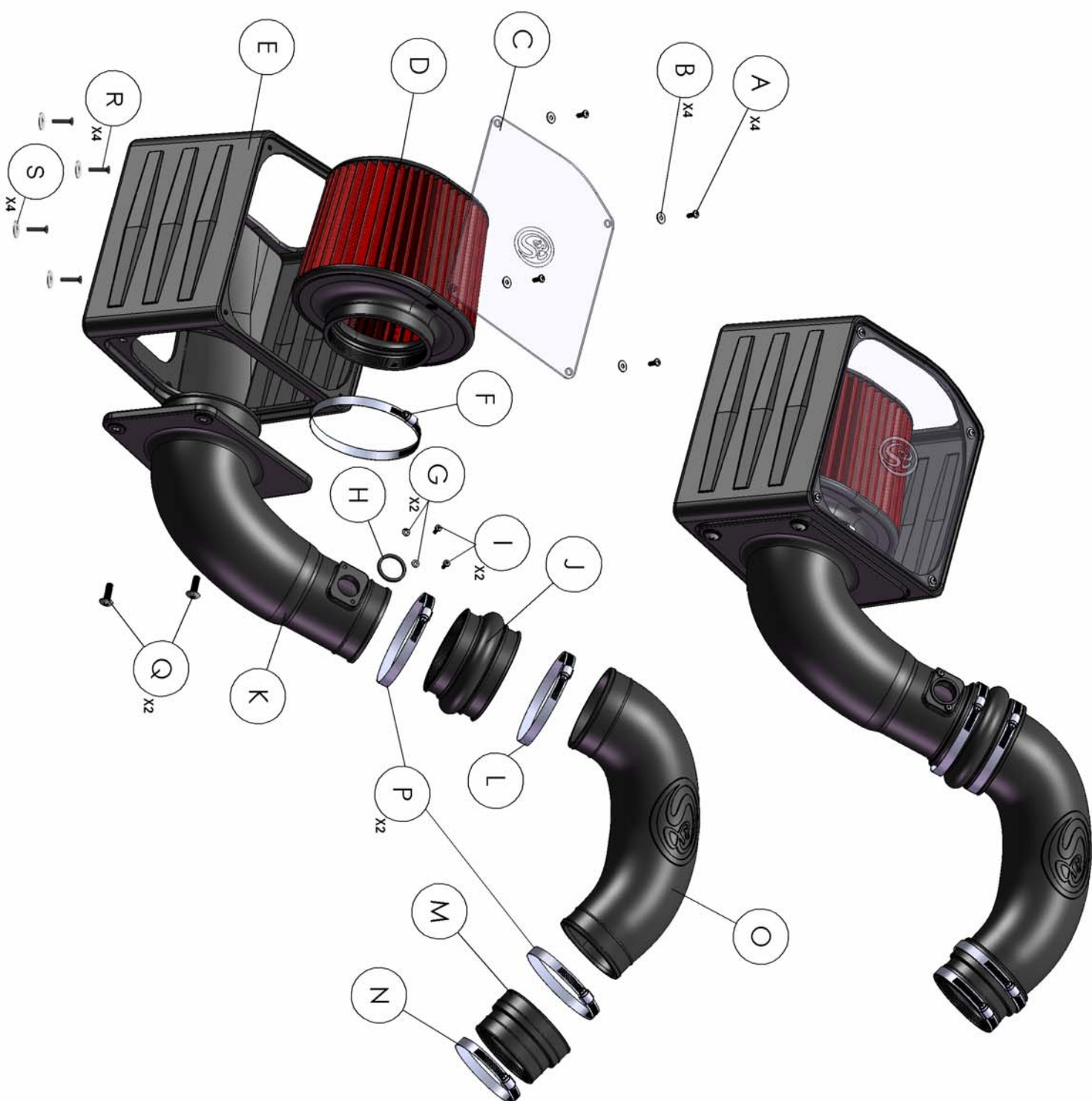



FILTERS
www.sbfilters.com

ADDENDUM to P/N 75-5038 Installation Instructions

If Equipped: and before step # 8, the OE plastic shield may need to be removed to allow clearance for the S&B Air Box.



Use a flat head screwdriver and or a suitable wrench to pry the push locks loose and remove the shield from the vehicle.

