



## INSTALLATION INSTRUCTIONS

### VEHICLE APPLICATION

Year: **2007.5-09**  
Make: **DODGE**  
Model: **RAM 2500/ 3500**  
Engine: **6.7L TURBO DIESEL**

### TOOLS REQUIRED

- 10mm Wrench & Socket
- 1/2" Wrench & Socket
- 7/16" Wrench & Socket
- 5/16" Nut Driver or Flat Blade Screwdriver
- Phillips Screwdriver, Pliers or Channel locks

### S&B FILTER OIL

Your Air Filter P/N: KF-1035 is factory oiled and ready to use. When serviced it will require:

- 87g - Main Body
- 17g - Power Stack (Top)

### NOTES

Kit may not fit with the following:

- Trucks with Remote Start option
- Aftermarket Parts installed
- Body Lift or Lowering Kit
- Custom Hood
- Intercooler or Turbo upgrades

### BEFORE YOU START

- Please read the entire product guide before proceeding.
- Ensure all components listed on page 4 are present.
- If you are missing any of the components, call our customer support at (909) 947-0015.
- Do not attempt to work on your vehicle while engine is hot.
- Make sure the engine is turned off and the vehicle is in Park or the Parking Brake is set.

**1.** With the ignition switched off and the parking brake set, disconnect the negative battery cables on both batteries.



**2.** Disconnect the electrical connection for the Intake Air Temp. (IAT) Sensor and the Mass Air Flow (MAF) Sensor then unsnap the wire loom from the tube. (See the next step for removal)



**3.** For the MAF sensor, Slide the **red** locking tab up then depress the **black** lever while disengaging the connector. For the IAT sensor just depress the **grey** lever while disengaging the connector.

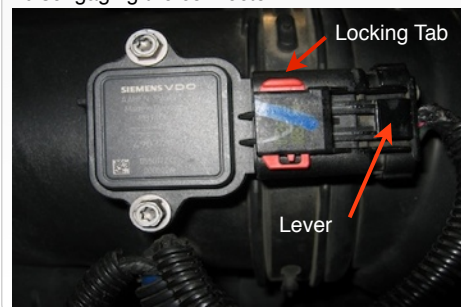

**4.** Loosen the hose clamp at the turbo inlet, next pinch the spring clamp and slide it up the steel piping. Then disconnect the silicone hose from the steel piping. You will reuse clamp for installation.



**5.** Remove the mounting nut on the stock air box.



**6.** Lift up and out to remove the stock air box assembly from the vehicle.

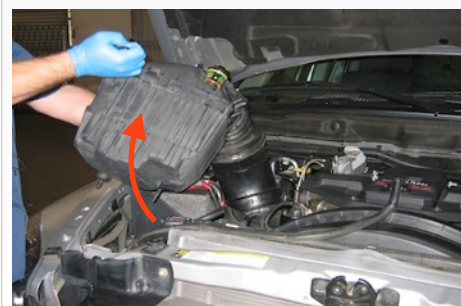

**7.** Carefully remove both sensors from the stock air box and set them aside for now.



**8.** Remove the PCV hose and barb from the stock intake tube. Set aside for now.



**9.** Install the new PCV Grommet (W) into the Intake tube (C). This is a tight fit to ensure an airtight seal. Use the round shank of the screwdriver and press the grommet in a circular motion against the tube wall.

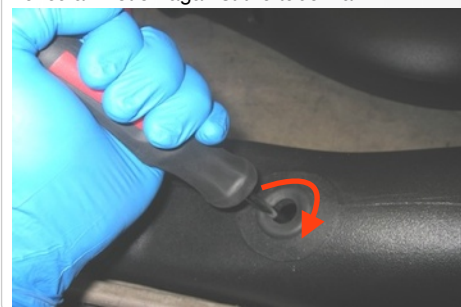

**SEE EXPLODED VIEW ON PAGE 4**



## **INSTALLATION INSTRUCTIONS (continued)**

10. Apply some lube to the tip of the stock PCV hose barb before inserting it into the grommet. Hold the grommet from inside the tube to prevent from pushing through during installation.



11. Place the Silicone adapter (B) and both #64 Hose Clamps (A) onto the turbo and secure the first clamp only.



12. Place the Hump Adapter (G) over the end of Intake Tube (C), slide on until nearly flush with the end of the tube. Include both #88 Hose Clamps (H) but leave loose at this time.



13. Use the supplied 8-32 SS Screws (F) and Sensor Gaskets (D) and (E), and install the MAF and IAT sensors that were removed in Step #7 into Intake Tube (C).



14. Slide the Intake tube assembly into the Adapter (B). Leave the clamp loose for now. Slip the PCV hose back onto the steel piping then slide the spring clamp back into position.



15. Attach the Splash Guard (V) to the Air Box (Q), use the supplied hardware to secure as instructed in the the exploded view.



16. Apply a light amount of grease to the two prongs on the bottom of the box (Q) before installing the Air Box assembly into the vehicle.



17. Attach the Air Box (Q) using the stock nut removed in Step #5. Leave loose at this time, it will be tightened in step #24.



18. Install the S&B Air Filter (J) to the Filter Adapter (K) and secure the #80 Hose Clamp (I). Position so the smaller end of the oval pointing upward.



19. Carefully place the filter assembly into the Air Box trying not to ding or gouge the wire mesh. Rotate the Filter Adapter (K) into position and hook the clip into the Air Box.



20. Install the Clear Lid (P) using the supplied 5/16" S.S. Screws (M) and Rubber Washers (L) along with the 10-24 Screws (N) and SS Sealing Washers (O). This will secure the Filter Adapter to the Air Box as well.



21. Slide the Hump Adapter (G) over the Filter Adapter (K) and secure the #88 Hose Clamp (H) on the Adapter only for now.



**SEE EXPLODED VIEW ON PAGE 4**



## **INSTALLATION INSTRUCTIONS (continued)**

22. While paying close attention to the coolant tube and oil filter, position the intake tube in place while tightening the #64 Hose Clamp (A) at the turbo.



23. It may necessary to rotate the two clamps 90 degrees on the coolant line to gain extra clearance from the intake tube.

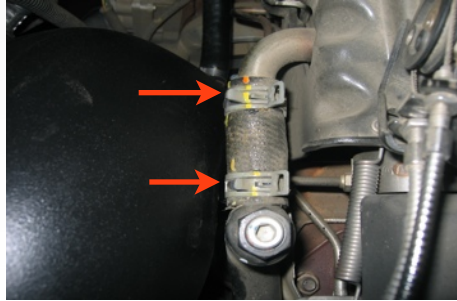

24. Tighten the second #88 Hose Clamp over the Hump Adapter (G) on the Intake Tube (C). Tighten down the Air Box mounting nut to the front frame rail.



25. Unclip and snip off the wire tie mounting the wiring harness above the alternator. Then re-route the wiring harness under the Intake Tube to reconnect the MAF and IAT sensors.



26. Reconnect both batteries. Inspect your installation, make sure the kit is properly positioned and all fasteners are secure. Affix the CARB sticker near the intake kit. The installation is now complete.



### **PRECISION FILTER CLEANING & OILING**



Order online today at [www.sbfilters.com](http://www.sbfilters.com) or through your local S&B distributor.

### **RELATED ITEMS FOR YOUR PURCHASE**

- Air Scoop Assembly (S&B P/N: 75-5049)
- Air Filter Wrap (S&B P/N: WF-1023)
- Water Protection Scoop Wrap (S&B P/N: WF-1028)
- Snow Cap Plug and Mounting Bracket kit (S&B P/N: 75-5051)

### **PERFORMANCE TESTING**

- Engage parking brake and start your engine. Listen for abnormal noises. If an air leak is detected, re-inspect hoses and connections as they may need to be repositioned and tightened.
- S&B FILTERS recommends that you keep your OE intake system in the event it is required in the future.
- In order to maintain your warranty, all connections and components must be checked periodically for alignment and for proper tension on all connections. Failure to do so may void your warranty.
- Use only S&B FILTERS cleaning and oil products to service your filter. Using any other brand oil and or cleaners on your S&B air filter may void your warranty.

**SEE EXPLODED VIEW ON PAGE 4**

### **EMISSIONS STANDARD**

The California Air Resource Board (CARB) requires that an E.O. identification label be applied to the vehicle in order to pass a smog check inspection when a Performance Intake Kit has been installed. You must place the E.O. label provided on or near the intake kit after installation so that a smog check technician can easily verify the E.O. number. As of April 2009, S&B has never had a product where CARB denied an exemption request; however, the exemption process with CARB can take as long as 18 months. Check the status of the exemption process by looking up a specific part number at [www.sbfilters.com](http://www.sbfilters.com). The CARB Exemption number and/or status is listed under the Product Details section for each part number. If the status shows as "Pending," CARB has yet to issue an exemption. Products that have not been issued an EO number are street legal in most states, but may not be used on emission controlled vehicles in the state of California and are for off road use only. If you purchased your kit from S&B Filters directly, we will automatically mail you your Exemption Sticker when it is issued to us. If you purchased your kit from an authorized S&B Filters Dealer, log onto our web site and register to receive your Exemption Sticker.



**EXPLODED VIEW**

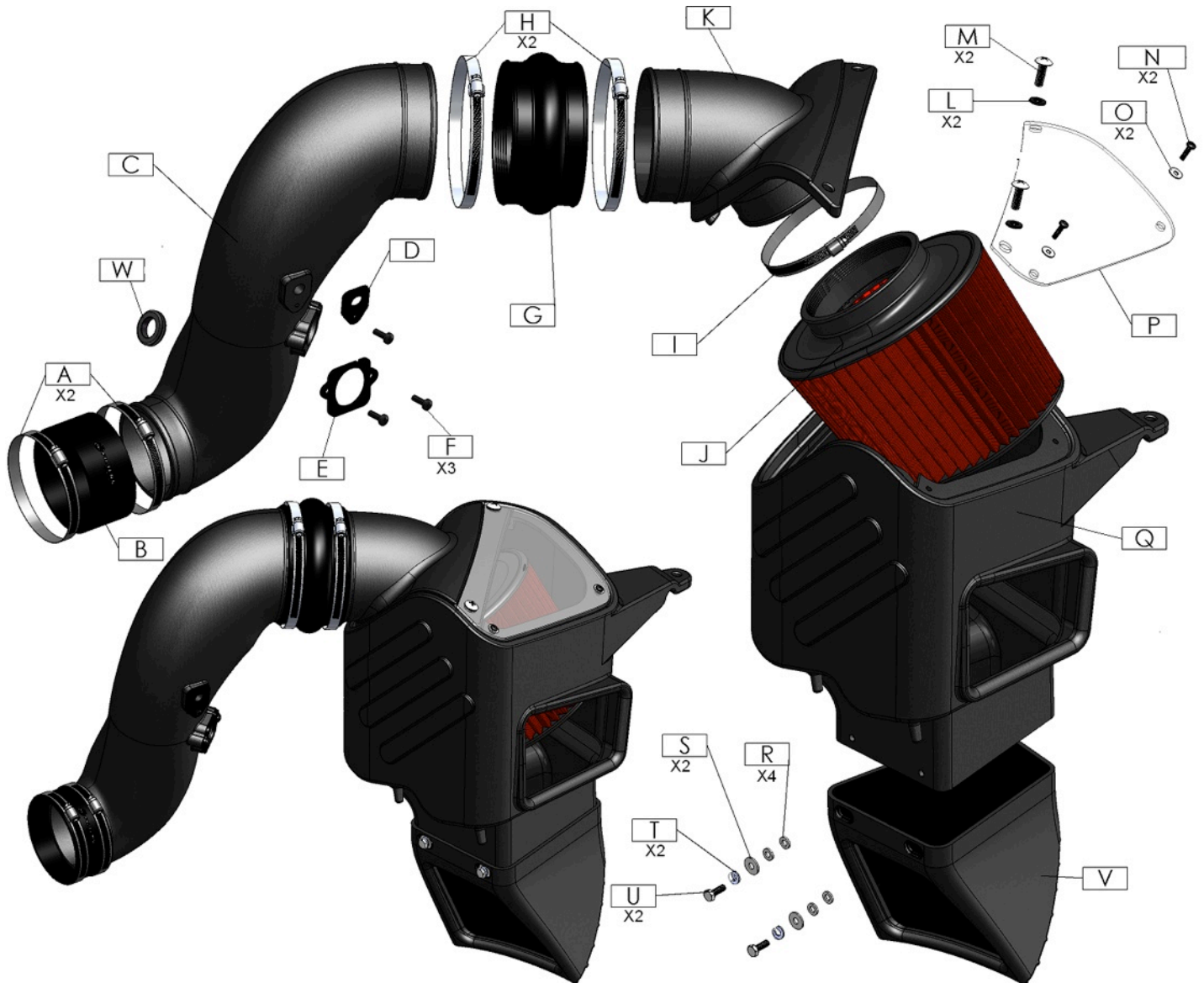

ITEM	QTY.	DESCRIPTION	P/N
A	2	Hose Clamp, #64	AI1018-00
B	1	Silicone Adapter, 4.10" x 2.5"	AI1333S-00
C	1	Intake Tube	AL1112-00
D	1	IAT Sensor Gasket	AI1302-00
E	1	MAF Sensor Gasket	AI1301-00
F	3	S.S. Screw, 8-32 x 1/2"	AI1479-00
G	1	Hump Adapter, 5.25" x 3.0"	AI1429-00
H	2	Hose Clamp, #88	AG1011-00
I	1	Hose Clamp, #80	AG1010-00
J	1	S&B Air Filter	KF-1035
K	1	Filter Adapter Tube	AL1112A-00
L	2	Rubber Washer	AI1435-00
M	2	S.S. Screw, 5/16-18 x 1.0"	AI1297-00
N	2	S.S. Screw, 10-24 x 1/2"	AI1287-00

ITEM	QTY.	DESCRIPTION	P/N
O	2	S.S. Sealing Washer, 10-24	AI1272-00
P	1	Clear Box Lid	AI1442-00
Q	1	S&B Air Box	AL1107-00
R	4	Spacer (Washer), 8mm	AI1402-00
S	2	Washer, Flat, 1/4"	AI1073-00
T	2	Washer, Lock, 1/4"	AI1309-00
U	2	Hex Bolt, 1/4-20 x 3/4"	AI1068-00
V	1	Splash Guard	AL1109-00
W	1	PCV Grommet	AI1478-00

AM0152-00 Rev.C 06/14/10